

CODICE · ITEM NO. ARTIKEL NR. · RÉFÉRENCE	DESCRIZIONE · DESCRIPTION EZEICHUNG · DESCRIPTION	PAGINA · PAGE SEITE · PAGE	
1640X	M - DIN371 ZEN-B HSS-P OX	126	
1740X	M - DIN376 ZEN-B HSS-P OX	128	
6640	M - DIN371 SP40° HSS	126	
6740	M - DIN376 SP40° HSS	128	
9640	M - DIN371 SP40° HSSE	126	
9740	M - DIN376 SP40° HSSE	128	
9640 LH	M - DIN371 LH SP40° HSSE	126	
9740 LH	M - DIN376 LH SP40° HSSE	128	
9644X	M - DIN371 SU2-SP-BLF HSSE OX	126	
9744X	M - DIN376 SU2-SP-BLF HSSE OX	128	
9645X	M - DIN371 SP45° HSSE VA-OX	127	
9745X	M - DIN376 SP45° HSSE VA-OX	129	
9645TC	M - DIN371 SP45° HSSE VA-TICN	127	
9745TC	M - DIN376 SP45° HSSE VA-TICN	129	
9646X	M - DIN371 SP45° HSSE NW-OX	127	
9746X	M - DIN376 SP45° HSSE NW-OX	129	
9648X	M - DIN371 SP40° HSSE PH-OX	127	
9748X	M - DIN376 SP40° HSSE PH-OX	129	
N-SP	M - JIS SP40° HSSE	127-129	
N-SP-LH	M - JIS LH SP40° HSSE	127-129	
9647	M - DIN371 SP40° BLF HSSE	130	
9747	M - DIN376 SP40° BLF HSSE	131	





CODICE · ITEM NO. ARTIKEL NR. · RÉFÉRENCE	DESCRIZIONE · DESCRIPTION EZEICHUNG · DESCRIPTION	PAGINA · PAGE SEITE · PAGE	
9647TC	M - DIN371 SP40° BLF HSSE TiCN	130	
9747TC	M - DIN376 SP40° BLF HSSE TiCN	131	
9647TI	M - DIN371 SP40° BLF HSSE TiN	130	
9747TI	M - DIN376 SP40° BLF HSSE TiN	131	
9647X	M - DIN371 SP40° BLF HSSE OX	130	
9747X	M - DIN376 SP40° BLF HSSE OX	131	
9642	M - DIN371 SP45° HSSE	132	
9742	M - DIN376 SP45° HSSE	133	
9642TC	M - DIN371 SP45° HSSE TiCN	132	
9742TC	M - DIN376 SP45° HSSE TiCN	133	
9642 2F	M - DIN371 2F SP45° HSSE	132	
9742 2F	M - DIN376 2F SP45° HSSE	133	
9643N	M - DIN371 SP45° HSSE AL-SP-NI	132	
9743N	M - DIN376 SP45° HSSE AL-SP-NI	133	
9643TC	M - DIN371 SP45° HSSE AL-SP TiCN	132	
9743TC	M - DIN376 SP45° HSSE AL-SP TiCN	133	
96406G	M - ISO3(6G) DIN371 SP40° HSSE	134	
97406G	M - ISO3(6G) DIN376 SP40° HSSE	135	
9640Ti6G	M - ISO3(6G) DIN371 SP40° HSSE TiN	134	
9740Ti6G	M - ISO3(6G) DIN376 SP40° HSSE TiN	135	
964005	M - ISO2 +0.05 DIN371 SP40° HSSE	134	
974005	M - ISO2 +0.05 DIN376 SP40° HSSE	135	



CODICE · ITEM NO. ARTIKEL NR. · RÉFÉRENCE	DESCRIZIONE · DESCRIPTION EZEICHUNG · DESCRIPTION	PAGINA · PAGE SEITE · PAGE	
964010	M - ISO2 +0.10 DIN371 SP40° HSSE	134	
974010	M - ISO2 +0.10 DIN376 SP40° HSSE	135	
OS-N-SP	M - ISO3(6G) JIS SP40° HSSE	134-135	
1641N	M - DIN371 ZET-B HSS-P NI	136	
1741N	M - DIN376 ZET-B HSS-P NI	138	
1641TC	M - DIN371 ZET-B HSS-P TiCN	136	
1741TC	M - DIN376 ZET-B HSS-P TiCN	138	
9641	M - DIN371 LO SP15° HSSE	136	
9741	M - DIN376 LO SP15° HSSE	138	
9641TC	M - DIN371 LO SP15° HSSE TiCN	136	
9741TC	M - DIN376 LO SP15° HSSE TiCN	138	
9641TI	M - DIN371 LO SP15° HSSE TiN	136	
9741TI	M - DIN376 LO SP15° HSSE TiN	138	
9641X	M - DIN371 LO SP15° HSSE OX	137	
9741X	M - DIN376 LO SP15° HSSE OX	139	
9641X6G	M - ISO3(6G) DIN371 LO SP15° HSSE OX	140	
9741X6G	M - ISO3(6G) DIN376 LO SP15° HSSE OX	141	
964105	M - ISO2 +0.05 DIN371 LO SP15° HSSE	140	
974105	M - ISO2 +0.05 DIN376 LO SP15° HSSE	141	
9641TI05	M - ISO2 +0.05 DIN371 LO SP15° HSSE TiN	140	
9741TI05	M - ISO2 +0.05 DIN376 LO SP15° HSSE TiN	141	
9641X05	M - ISO2 +0.05 DIN371 LO SP15° HSSE OX	140	



CODICE · ITEM NO. ARTIKEL NR. · RÉFÉRENCE	DESCRIZIONE · DESCRIPTION EZEICHUNG · DESCRIPTION	PAGINA · PAGE SEITE · PAGE	
9741X05	M - ISO2 +0.05 DIN376 LO15° HSSE OX	141	
964110	M - ISO2 +0.10 DIN371 LO15° HSSE	140	
974110	M - ISO2 +0.10 DIN376 LO15° HSSE	141	

MASCHI A MACCHINA PER FORI CIECHI

BLIND HOLES MACHINE TAPS

MASCHINENGEWINDEBOHRER FÜR GRUNDLÖCHER

TARAUDS MACHINE POUR TROUS BORGNES

M
DIN371
JIS

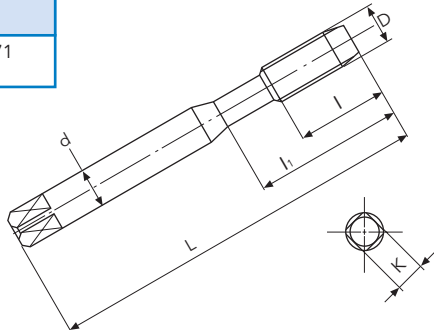

GRUPPI MATERIALE - MATERIAL GROUPS		WERKSTOFFE GRUPPE - GROUPES MATIÈRE		4 5 6 8 9 10 20 21		1 2 3 4 14 16 17 18 19		1 2 3 4 14 16 17 18 19		1 2 3 4 14 16 17 18 19		10	
CODICE / ITEM NO. / ARTIKEL NR. / RÉFÉRENCE		1640X		6640		9640		9640LH		9644X			
TIPO / TYPE / TYP / TYPE		ZEN-B		SP40°		SP40°		SPLH40°		SU2-SP(BLF)			
MATERIALE / MATERIAL / WERKSTOFF / MATIÈRE		HSS-P		HSS		HSSE		HSSE		HSSE			
RIVESTIMENTO / COATING / BESCHICHTUNG / REVÊTEMENT		OX		BR		BR		BR		OX			
NORMA / NORM / NORM / NORME		DIN371		DIN371		DIN371		DIN371		DIN371			
TOLLERANZA / TOLERANCE / TOLERANZ / TOLÉRANCE		ISO2X(6HX)		ISO2(6H)		ISO2(6H)		ISO2(6H)		ISO2(6H)			
IMBOCCO / CHAMFER / ANSCHNITT / ENTRÉE		3P		C(2P~3P)		C(2P~3P)		C(2P~3P)		C(2P~3P)			
D	p	Ø	L	l	*	l1	d	k	Stock	Stock	Stock	Stock	Stock
M 1	0.25	0.75	40	5.5			2.5	2.1					
M 1.1	0.25	0.85	40	5.5			2.5	2.1					
M 1.2	0.25	0.95	40	5.5			2.5	2.1					
M 1.4	0.3	1.1	40	7			2.5	2.1					
M 1.6	0.35	1.25	40	8			2.5	2.1					
M 1.7	0.35	1.35	40	8			2.5	2.1					
M 1.8	0.35	1.45	40	8			2.5	2.1					
M 2	0.4	1.6	45	4		9	2.8	2.1			●		△
M 2.2	0.45	1.75	45	4		12	2.8	2.1			●		
M 2.3	0.4	1.9	45	4		12	2.8	2.1			●		
M 2.5	0.45	2.1	50	4		12.5	2.8	2.1			●		△
M 2.6	0.45	2.2	50	4		12.5	2.8	2.1			●		
M 3	0.5	2.5	56	5	11	18	3.5	2.7	●	●	●	○	●
3 M	0.6	2.4	46	9.5		18	4	3.2					
M 3.5	0.6	2.9	56	7		20	4	3			●		
M 4	0.7	3.3	63	7	13	21	4.5	3.4	●	●	●	○	●
4 M	0.75	3.25	52	13		21	5	4					
M 5	0.8	4.2	70	9	16	25	6	4.9	●	●	●	●	●
5 M	0.9	4.1	60	16		25	5.5	4.5					
M 6	1	5	80	11	19	30	6	4.9	●	●	●	●	●
M 7	1	6	80	11		30	7	5.5			●		
M 8	1.25	6.8	90	12	22	35	8	6.2	●	●	●	●	●
M 9	1.25	7.8	90	12		35	9	7					
M10	1.5	8.5	100	13	24	39	10	8	●	●	●	●	

JIS NORM page 53

*I-9644X

**P CLASS page 47



M 1 ~ M 2.6			2		2
M 3	3	3	3	3	2
M 3.5 ~ M10	3	3	3	3	3

MASCHI A MACCHINA PER FORI CIECHI

BLIND HOLES MACHINE TAPS

MASCHINENGEWINDEBOHRER FÜR GRUNDLÖCHER

TARAUDS MACHINE POUR TROUS BORGNES



~HRC37

FILETTATURA SINISTRA · LEFT-HAND THREAD
LINKSGEWINDE · FILETAGE À GAUCHE

1 2 3 4 8 9	1 2 3 4 8 9	1 18	5 6	1 2 3 4 14 16 17 18 19	1 2 3 4 14 16 17 18 19	D	p
9645X	9645TC	9646X	9648X	N-SP	N-SP-LH		
SPVA45°	SPVA45°	SPNW45°	PH-SP40°	SP40°	SPLH40°		
HSSE	HSSE	HSSE	HSSE	HSSE	HSSE		
OX	TiCN	OX	OX	BR	BR		
DIN371	DIN371	DIN371	DIN371	JIS	JIS		
ISO2(6H)	ISO2(6H)	ISO2(6H)	ISO2(6H)	P CLASS**	P CLASS**		
C(2P~3P)	C(2P~3P)	C(2P~3P)	3P	2.5P	2.5P		
Stock	Stock	Stock	Stock	Stock	Stock		
				○ (P1)		M 1	0.25
				○ (P1)		M 1.1	0.25
				○ (P1)		M 1.2	0.25
				○ (P1)		M 1.4	0.3
				○ (P1)		M 1.6	0.35
				○ (P1)		M 1.7	0.35
				○ (P1)		M 1.8	0.35
●				○ (P1)	○ (P1)	M 2	0.4
				○ (P1)		M 2.2	0.45
				○ (P1)		M 2.3	0.4
●				○ (P1)	○ (P1)	M 2.5	0.45
				○ (P1)	○ (P1)	M 2.6	0.45
●	○	●	●	○ (P1)	○ (P1)	M 3	0.5
				○ (P1)		3 M	0.6
				○ (P1)		M 3.5	0.6
●	●	●	●	○ (P2)	○ (P2)	M 4	0.7
				○ (P2)		4 M	0.75
●	●	●	●	○ (P2)	○ (P2)	M 5	0.8
				○ (P2)		5 M	0.9
●	●	●	●	○ (P2)	○ (P2)	M 6	1
				○ (P2)	○ (P2)	M 7	1
●	●	●	●	○ (P2)	○ (P2)	M 8	1.25
				△ (P2)		M 9	1.25
●	●	●	●	○ (P2)	○ (P2)	M10	1.5

				2	2	M 1 ~ M 2.6
2	3	3	3	3	3	M 3
3	3	3	3	3	3	M 3.5 ~ M10

- MASCHI A MACCHINA PER FORI CIECHI**
- BLIND HOLES MACHINE TAPS**
- MASCHINENGEWINDEBOHRER FÜR GRUNDLÖCHER**
- TARAUDS MACHINE POUR TROUS BORGNES**

M
 DIN376
JIS

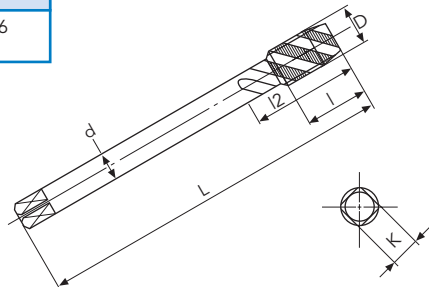

FILETTATURA SINISTRA · LEFT-HAND THREAD
 LINKSGEWINDE · FILETAGE À GAUCHE

GRUPPI MATERIALE · MATERIAL GROUPS		4 5 6 8		1 2 3 4 14		1 2 3 4 14		1 2 3 4 14		10			
WERKSTOFFE GRUPPE · GROUPES MATIÈRE		9 10 20 21		16 17 18 19		16 17 18 19		16 17 18 19					
CODICE / ITEM NO. / ARTIKEL NR. / RÉFÉRENCE		1740X		6740		9740		9740LH		9744X			
TIPO / TYPE / TYP / TYPE		ZEN-B		SP40°		SP40°		SPLH40°		SU2-SP(BLF)			
MATERIALE / MATERIAL / WERKSTOFF / MATIÈRE		HSS-P		HSS		HSSE		HSSE		HSSE			
RIVESTIMENTO / COATING / BESCHICHTUNG / REVÊTEMENT		OX		BR		BR		BR		OX			
NORMA / NORM / NORM / NORME		DIN376		DIN376		DIN376		DIN376		DIN376			
TOLLERANZA / TOLERANCE / TOLERANZ / TOLÉRANCE		ISO2X(6HX)		ISO2(6H)		ISO2(6H)		ISO2(6H)		ISO2(6H)			
IMBOCCO / CHAMFER / ANSCHNITT / ENTRÉE		3P		C(2P~3P)		C(2P~3P)		C(2P~3P)		C(2P~3P)			
D	p	Ø	L	l	*	l2	d	k	Stock	Stock	Stock	Stock	Stock
M 3	0.5	2.5	56	5		17	2.2				●		
M 4	0.7	3.3	63	7		19	2.8	2.1			●		
M 5	0.8	4.2	70	9		22	3.5	2.7			●		
M 6	1	5	80	11		25	4.5	3.4			●		
M 8	1.25	6.8	90	12		28	6	4.9			●		
M10	1.5	8.5	100	13		35	7	5.5			●		
M12	1.75	10.3	110	15	29	42	9	7	●	●	●	●	●
M14	2	12	110	18	30	49	11	9	●	●	●	●	●
M16	2	14	110	18	32	56	12	9	●	●	●	●	●
M18	2.5	15.5	125	20	34	63	14	11	●	●	●	●	○
M20	2.5	17.5	140	20	34	70	16	12	●	●	●	●	●
M22	2.5	19.5	140	20	34	77	18	14.5	●	●	●	●	○
M24	3	21	160	25	38	84	18	14.5	●	●	●	●	○
M27	3	24	160	25		95	20	16			●	●	
M30	3.5	26.5	180	30		105	22	18			●	●	
M33	3.5	29.5	180	30		115	25	20				△	
M36	4	32	200	40		126	28	22				△	
M39	4	35	200	40		135	32	24				△	
M42	4.5	37.5	200	40		135	32	24				△	
M45	4.5	40.5	220	45		155	36	29				△	
M48	5	43	250	45		168	36	29				△	

JIS NORM page 53

*I-9744X

**P CLASS page 47



M 3 ~ M10		3	3	3	3
M12 ~ M16	3	3	3	3	3
M18 ~ M20	4	4	4	4	4
M22 ~ M48	4	4	4	4	4

MASCHI A MACCHINA PER FORI CIECHI

BLIND HOLES MACHINE TAPS

MASCHINENGEWINDEBOHRER FÜR GRUNDLÖCHER

TARAUDS MACHINE POUR TROUS BORGNES



1 2 3 4 8 9	1 2 3 4 8 9	1 18	5 6	1 2 3 4 14 16 17 18 19	1 2 3 4 14 16 17 18 19	D	p
9745X	9745TC	9746X	9748X	N-SP	N-SP-LH		
SPVA45°	SPVA45°	SPNW45°	PH-SP40°	SP40°	SPLH40°		
HSSE	HSSE	HSSE	HSSE	HSSE	HSSE		
OX	TiCN	OX	OX	BR	BR		
DIN376	DIN376	DIN376	DIN376	JIS	JIS		
ISO2(6H)	ISO2(6H)	ISO2(6H)	ISO2(6H)	P CLASS**	P CLASS**		
C(2P~3P)	C(2P~3P)	C(2P~3P)	3P	2.5P	2.5P		
Stock	Stock	Stock	Stock	Stock	Stock		
						M 3	0.5
						M 4	0.7
						M 5	0.8
						M 6	1
●						M 8	1.25
●						M10	1.5
●	●	●	●	○ (P2)	○ (P2)	M12	1.75
●	○	●	●	○ (P2)	○ (P2)	M14	2
●	○	●	●	○ (P2)	○ (P2)	M16	2
●	△	●	●	○ (P3)	○ (P3)	M18	2.5
●	△	●	●	○ (P3)	○ (P3)	M20	2.5
●	△	●	●	○ (P3)	○ (P3)	M22	2.5
●	△	●	●	○ (P3)	○ (P3)	M24	3
				○ (P3)	○ (P3)	M27	3
				○ (P4)	○ (P4)	M30	3.5
				○ (P4)		M33	3.5
				○ (P4)		M36	4
						M39	4
						M42	4.5
						M45	4.5
						M48	5

3	3	4	4	3	3	M12 ~ M16
4	4	4	4	4	4	M18 ~ M20
4	4	5	4	4	4	M22 ~ M48

FILETTATURA SINISTRA · LEFT-HAND THREAD
LINKSGEWINDE · FILETTAGE À GAUCHE

MASCHI A MACCHINA PER FORI CIECHI PROFONDI - BLF

DEEP BLIND HOLES MACHINE TAPS - BLF

MASCHINENGEWINDEBOHRER FÜR TIEFE GRUNDLÖCHER - BLF

TARAUDS MACHINE POUR TROUS BORGNES PROFONDS - BLF

M
DIN371

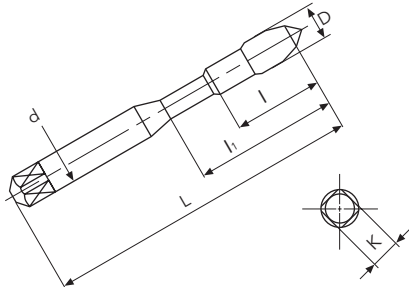

GRUPPI MATERIALE · MATERIAL GROUPS WERKSTOFFE GRUPPE · GROUPES MATIÈRE		2	3	4	2	3	4	2	3	4	2	3	4
CODICE / ITEM NO. / ARTIKEL NR. / RÉFÉRENCE		9647		9647TC		9647TI		9647X					
TIPO / TYPE / TYP / TYPE		SP40°(BLF)		SP40°(BLF)		SP40°(BLF)		SP40°(BLF)					
MATERIALE / MATERIAL / WERKSTOFF / MATIÈRE		HSSE		HSSE		HSSE		HSSE					
RIVESTIMENTO / COATING / BESCHICHTUNG / REVÊTEMENT		BR		TiCN		TiN		OX					
NORMA / NORM / NORM / NORME		DIN371		DIN371		DIN371		DIN371					
TOLLERANZA / TOLERANCE / TOLERANZ / TOLÉRANCE		ISO2(6H)		ISO2(6H)		ISO2(6H)		ISO2(6H)					
IMBOCCO / CHAMFER / ANSCHNITT / ENTRÉE		C(2P~3P)		C(2P~3P)		C(2P~3P)		C(2P~3P)					
D	p		L	l	l1	d	k	Stock	Stock	Stock	Stock		
M 3	0.5	2.5	56	11	18	3.5	2.7	●	●	●	●		
M 4	0.7	3.3	63	13	21	4.5	3.4	●	●	●	●		
M 5	0.8	4.2	70	16	25	6	4.9	●	●	●	●		
M 6	1	5	80	19	30	6	4.9	●	●	●	●		
M 8	1.25	6.8	90	22	35	8	6.2	●	●	●	●		
M10	1.5	8.5	100	24	39	10	8	●	●	●	●		



M 3 ~ M10	3	3	3	3
------------------	---	---	---	---

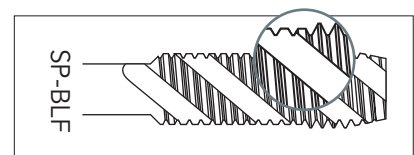

🇮🇹 MASCHI A MACCHINA PER FORI CIECHI PROFONDI - BLF

🇬🇧 DEEP BLIND HOLES MACHINE TAPS - BLF

🇩🇪 MASCHINENGEWINDEBOHRER FÜR TIEFE GRUNDLÖCHER - BLF

🇫🇷 TARAUDS MACHINE POUR TROUS BORGNES PROFONDS - BLF

M
DIN376

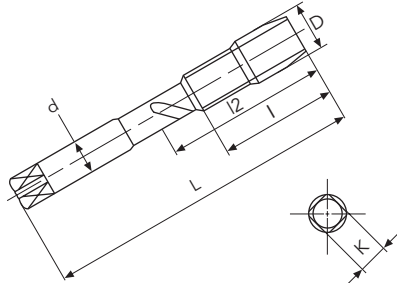

GRUPPI MATERIALE · MATERIAL GROUPS WERKSTOFFE GRUPPE · GROUPES MATIÈRE								2	3	4	2	3	4	2	3	4	2	3	4
CODICE / ITEM NO. / ARTIKEL NR. / RÉFÉRENCE								9747	9747TC	9747TI	9747	9747TC	9747TI	9747	9747TC	9747TI	9747	9747TC	9747TI
TIPO / TYPE / TYP / TYPE								SP40°(BLF)	SP40°(BLF)	SP40°(BLF)	SP40°(BLF)	SP40°(BLF)	SP40°(BLF)	SP40°(BLF)	SP40°(BLF)	SP40°(BLF)	SP40°(BLF)	SP40°(BLF)	
MATERIALE / MATERIAL / WERKSTOFF / MATIÈRE								HSSE	HSSE	HSSE	HSSE	HSSE	HSSE	HSSE	HSSE	HSSE	HSSE	HSSE	
RIVESTIMENTO / COATING / BESCHICHTUNG / REVÊTEMENT								BR	TiCN	TiN	BR	TiCN	TiN	BR	TiCN	TiN	BR	TiCN	TiN
NORMA / NORM / NORM / NORME								DIN376	DIN376	DIN376	DIN376	DIN376	DIN376	DIN376	DIN376	DIN376	DIN376	DIN376	
TOLLERANZA / TOLERANCE / TOLERANZ / TOLÉRANCE								ISO2(6H)	ISO2(6H)	ISO2(6H)	ISO2(6H)	ISO2(6H)	ISO2(6H)	ISO2(6H)	ISO2(6H)	ISO2(6H)	ISO2(6H)	ISO2(6H)	
IMBOCCO / CHAMFER / ANSCHNITT / ENTRÉE								C(2P~3P)	C(2P~3P)	C(2P~3P)	C(2P~3P)	C(2P~3P)	C(2P~3P)	C(2P~3P)	C(2P~3P)	C(2P~3P)	C(2P~3P)		
D	p	Ø	L	l	l2	d	k	Stock	Stock	Stock	Stock	Stock	Stock	Stock	Stock	Stock	Stock	Stock	
M12	1.75	10.3	110	29	42	9	7	●	●	●	●	●	●	●	●	●	●	●	
M14	2	12	110	30	49	11	9	●	●	●	●	●	●	●	●	●	●	●	
M16	2	14	110	32	56	12	9	●	●	●	●	●	●	●	●	●	●	●	
M18	2.5	15.5	125	34	63	14	11	●	●	●	●	●	●	●	●	●	●	●	
M20	2.5	17.5	140	34	70	16	12	●	●	●	●	●	●	●	●	●	●	●	
M22	2.5	19.5	140	34	77	18	14.5	●	●	●	●	●	●	●	●	●	●	●	
M24	3	21	160	38	84	18	14.5	●	●	●	●	●	●	●	●	●	●	●	
M27	3	24	160	38	95	20	16											●	
M30	3.5	26.5	180	45	105	22	18											●	
M33	3.5	29.5	180	50	115	25	20											●	
M36	4	32	200	55	126	28	22											●	
M39	4	35	200	60	135	32	24											△	
M42	4.5	37.5	200	60	135	32	24											△	
M45	4.5	40.5	220	65	155	36	29											△	
M48	5	43	250	70	168	36	29											△	



M12 ~ M16	3	3	3	3
M18 ~ M20	4	4	4	4
M22 ~ M48	4	4	4	4

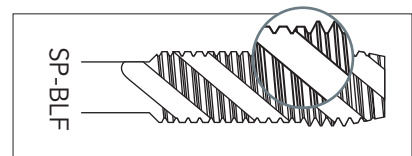

MASCHI A MACCHINA PER FORI CIECHI - **ALLUMINIO**

BLIND HOLES MACHINE TAPS - **ALUMINIUM**

MASCHINENGEWINDEBOHRER FÜR GRUNDLÖCHER - **ALUMINIUM**

TARAUDS MACHINE POUR TROUS BORGNES - **ALUMINIUM**

M
DIN371

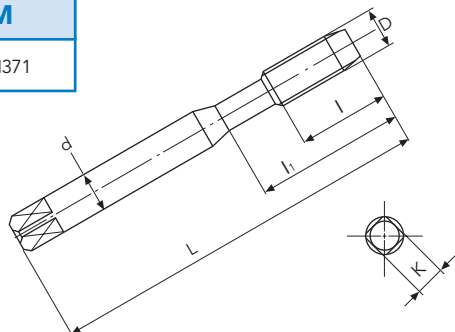

GRUPPI MATERIALE - MATERIAL GROUPS WERKSTOFFE GRUPPE - GROUPES MATIÈRE		16	16	16	17	17							
CODICE / ITEM NO. / ARTIKEL NR. / RÉFÉRENCE		9642	9642TC	9642 2F	9643N	9643TC							
TIPO / TYPE / TYP / TYPE		HISP45°	HISP45°	HISP45°	ALSP45°	ALSP45°							
MATERIALE / MATERIAL / WERKSTOFF / MATIÈRE		HSSE	HSSE	HSSE	HSSE	HSSE							
RIVESTIMENTO / COATING / BESCHICHTUNG / REVÊTEMENT		BR	TiCN	BR	NI	TiCN							
NORMA / NORM / NORM / NORME		DIN371	DIN371	DIN371	DIN371	DIN371							
TOLLERANZA / TOLERANCE / TOLERANZ / TOLÉRANCE		ISO2(6H)	ISO2(6H)	ISO2(6H)	ISO2X(6HX)	ISO2X(6HX)							
IMBOCCO / CHAMFER / ANSCHNITT / ENTRÉE		C(2P~3P)	C(2P~3P)	C(2P~3P)	C(2P~3P)	C(2P~3P)							
D	p	Ø	L	l	*	l1	d	k	Stock	Stock	Stock	Stock	Stock
M 2	0.4	1.6	45	4	6	9	2.8	2.1	●	○	9642	●	○
M 2.5	0.45	2.1	50	4	7	12.5	2.8	2.1	●	○	9642	●	○
M 2.6	0.45	2.2	50	4		12.5	2.8	2.1					
M 3	0.5	2.5	56	5	11	18	3.5	2.7	●	●	●	●	●
M 3.5	0.6	2.9	56	7		20	4	3					
M 4	0.7	3.3	63	7	13	21	4.5	3.4	●	●	●	●	●
M 5	0.8	4.2	70	9	16	25	6	4.9	●	●	●	●	●
M 6	1	5	80	11	19	30	6	4.9	●	●	●	●	●
M 8	1.25	6.8	90	12	22	35	8	6.2	●	●	△	●	●
M10	1.5	8.5	100	13	24	39	10	8	●	●	△	●	●

*I-9643N, 9643TC



M 2 ~ M 2.6	2	2	2	2
M 3 ~ M10	3	3	2	3

MASCHI A MACCHINA PER FORI CIECHI - ALLUMINIO

BLIND HOLES MACHINE TAPS - ALUMINIUM

MASCHINENGEWINDEBOHRER FÜR GRUNDLÖCHER - ALUMINIUM

TARAUDS MACHINE POUR TROUS BORGNES - ALUMINIUM

M
DIN376

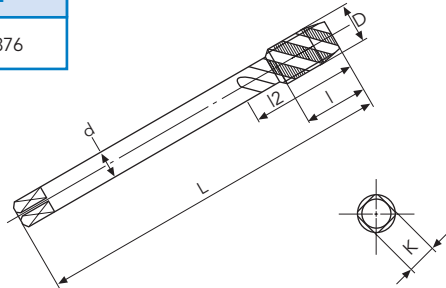

GRUPPI MATERIALE · MATERIAL GROUPS WERKSTOFFE GRUPPE · GROUPES MATIÈRE		16	16	16	17	17							
CODICE / ITEM NO. / ARTIKEL NR. / RÉFÉRENCE		9742	9742TC	9742 2F	9743N	9743TC							
TIPO / TYPE / TYP / TYPE		HISP45°	HISP45°	HISP45°	ALSP45°	ALSP45°							
MATERIALE / MATERIAL / WERKSTOFF / MATIÈRE		HSSE	HSSE	HSSE	HSSE	HSSE							
RIVESTIMENTO / COATING / BESCHICHTUNG / REVÊTEMENT		BR	TiCN	BR	NI	TiCN							
NORMA / NORM / NORM / NORME		DIN376	DIN376	DIN376	DIN376	DIN376							
TOLLERANZA / TOLERANCE / TOLERANZ / TOLÉRANCE		ISO2(6H)	ISO2(6H)	ISO2(6H)	ISO2X(6HX)	ISO2X(6HX)							
IMBOCCO / CHAMFER / ANSCHNITT / ENTRÉE		C(2P~3P)	C(2P~3P)	C(2P~3P)	C(2P~3P)	C(2P~3P)							
D	p	Ø	L	l	*	l2	d	k	Stock	Stock	Stock	Stock	Stock
M12	1.75	10.3	110	15	29	42	9	7	●	○	△	●	○
M14	2	12	110	18	30	49	11	9	●	○	△	●	○
M16	2	14	110	18	32	56	12	9	●	○	△	●	○
M18	2.5	15.5	125	20		63	14	11	○				
M20	2.5	17.5	140	20		70	16	12	●				

*I-9743N, 9743TC



M12 ~ M16	3	3	2	3	3
M18 ~ M20	4	4			

🇮🇹 MASCHI A MACCHINA PER FORI CIECHI - MAGGIORATI

🇬🇧 BLIND HOLES MACHINE TAPS - OVERSIZED

🇩🇪 MASCHINENGEWINDEBOHRER FÜR GRUNDLÖCHER - ÜBERMAß

🇫🇷 TARAUDS MACHINE POUR TROUS BORGNES - SURCOTÉS

M
DIN371
JIS

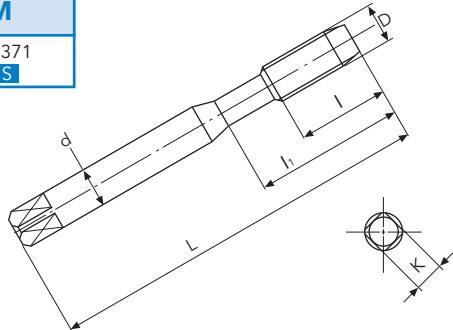

GRUPPI MATERIALE · MATERIAL GROUPS		1	2	3	4	14	1	2	3	4	14	1	2	3	4	14	1	2	3	4	14	1	2	3	4	14
WERKSTOFFE GRUPPE · GROUPES MATIÈRE		16	17	18	19	16	17	18	19	16	17	18	19	16	17	18	19	16	17	18	19	16	17	18	19	
CODICE / ITEM NO. / ARTIKEL NR. / RÉFÉRENCE		96406G					9640T16G					964005					964010					OS-N-SP				
TIPO / TYPE / TYP / TYPE		SP40°					SP40°					SP40°					SP40°					SP40°				
MATERIALE / MATERIAL / WERKSTOFF / MATIÈRE		HSSE					HSSE					HSSE					HSSE					HSSE				
RIVESTIMENTO / COATING / BESCHICHTUNG / REVÊTEMENT		BR					TIN					BR					BR					BR				
NORMA / NORM / NORM / NORME		DIN371					DIN371					DIN371					DIN371					JIS				
TOLLERANZA / TOLERANCE / TOLERANZ / TOLÉRANCE		ISO3(6G)					ISO3(6G)					ISO2(6H)+0.05					ISO2(6H)+0.10					P CLASS*				
IMBOCCO / CHAMFER / ANSCHNITT / ENTRÉE		C(2P~3P)					C(2P~3P)					C(2P~3P)					C(2P~3P)					2.5P				
D	p	Ø	L	l	l1	d	k	Stock	Stock	Stock	Stock	Stock	Stock	Stock	Stock	Stock	Stock	Stock	Stock	Stock	Stock	Stock	Stock	Stock		
M 2	0.4	1.6	45	4		2.8	2.1	△	△	△	△	△	△	△	△	△	△	△	△	△	△	△	△	△	○ (P3)	
M 2.5	0.45	2.1	50	4		2.8	2.1	△	△	△	△	△	△	△	△	△	△	△	△	△	△	△	△	△	○ (P3)	
M 2.6	0.45	2.2	50	4		2.8	2.1																			
M 3	0.5	2.5	56	5	18	3.5	2.7	●	○	△	△	△	△	△	△	△	△	△	△	△	△	△	△	△	○ (P3)	
M 3.5	0.6	2.9	56	7	20	4	3																		○ (P4)	
M 4	0.7	3.3	63	7	21	4.5	3.4	●	○	△	△	△	△	△	△	△	△	△	△	△	△	△	△	△	○ (P4)	
M 5	0.8	4.2	70	9	25	6	4.9	●	○	△	△	△	△	△	△	△	△	△	△	△	△	△	△	△	○ (P4)	
M 6	1	5	80	11	30	6	4.9	●	○	△	△	△	△	△	△	△	△	△	△	△	△	△	△	△	○ (P4)	
M 8	1.25	6.8	90	12	35	8	6.2	●	○	△	△	△	△	△	△	△	△	△	△	△	△	△	△	△	○ (P4)	
M10	1.5	8.6	100	13	39	10	8	●	○	△	△	△	△	△	△	△	△	△	△	△	△	△	△	△		

JIS NORM page 53

*P CLASS page 47



M 2 ~ M 2.6	2	2	2	2	2
M 3 ~ M10	3	3	3	3	3

🇮🇹 MASCHI A MACCHINA PER FORI CIECHI - MAGGIORATI

🇬🇧 BLIND HOLES MACHINE TAPS - OVERSIZED

🇩🇪 MASCHINENGEWINDEBOHRER FÜR GRUNDLÖCHER - ÜBERMAß

🇫🇷 TARAUDS MACHINE POUR TROUS BORGNES - SURCOTÉS

M
DIN376 JIS

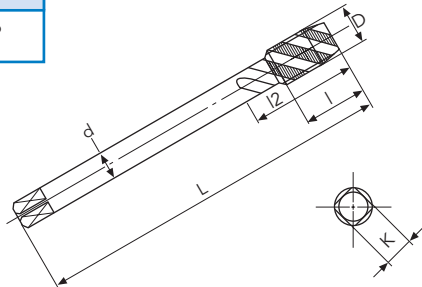

GRUPPI MATERIALE · MATERIAL GROUPS WERKSTOFFE GRUPPE · GROUPES MATIÈRE	1 2 3 4 14 16 17 18 19	1 2 3 4 14 16 17 18 19	1 2 3 4 14 16 17 18 19	1 2 3 4 14 16 17 18 19	1 2 3 4 14 16 17 18 19							
CODICE / ITEM NO. / ARTIKEL NR. / RÉFÉRENCE	97406G	9740T16G	974005	974010	OS-N-SP							
TIPO / TYPE / TYP / TYPE	SP40°	SP40°	SP40°	SP40°	SP40°							
MATERIALE / MATERIAL / WERKSTOFF / MATIÈRE	HSSE	HSSE	HSSE	HSSE	HSSE							
RIVESTIMENTO / COATING / BESCHICHTUNG / REVÊTEMENT	BR	TIN	BR	BR	BR							
NORMA / NORM / NORM / NORME	DIN376	DIN376	DIN376	DIN376	JIS							
TOLLERANZA / TOLERANCE / TOLERANZ / TOLÉRANCE	ISO3(6G)	ISO3(6G)	ISO2(6H)+0.05	ISO2(6H)+0.10	P CLASS*							
IMBOCCO / CHAMFER / ANSCHNITT / ENTRÉE	C(2P~3P)	C(2P~3P)	C(2P~3P)	C(2P~3P)	C(2P~3P)							
D	p	∅	L	l	l2	d	k	Stock	Stock	Stock	Stock	Stock
M12	1.75	10.3	110	29	42	9	7	●	○	△	△	
M14	2	12	110	30	49	11	9	●	○	△	△	
M16	2	14	110	32	56	12	9	●	○	△	△	
M18	2.5	15.5	125	34	63	14	11	△	△	△	△	
M20	2.5	17.5	140	34	70	16	12	△	△	△	△	

JIS NORM page 53

*P CLASS page 47



M12 ~ M16	3	3	3	3	3
M18 ~ M20	4	4	4	4	4

- MASCHI A MACCHINA PER FORI CIECHI**
- BLIND HOLES MACHINE TAPS**
- MASCHINENGEWINDEBOHRER FÜR GRUNDLÖCHER**
- TARAUDS MACHINE POUR TROUS BORGNES**

M
DIN371

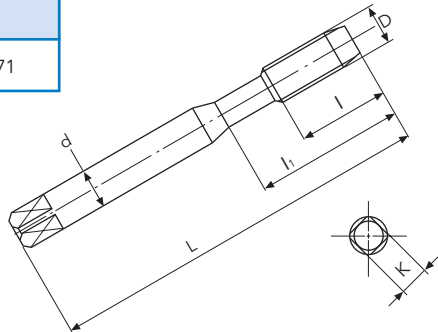

GRUPPI MATERIALE · MATERIAL GROUPS WERKSTOFFE GRUPPE · GROUPES MATIÈRE		4 5 22	4 5	2 3 4 5 14 19	2 3 4 5 14 19	2 3 4 5 14 19							
CODICE / ITEM NO. / ARTIKEL NR. / RÉFÉRENCE		1641N	1641TC	9641	9641TC	9641TI							
TIPO / TYPE / TYP / TYPE		ZET-B	ZET-B	LOSP 20°	LOSP 20°	LOSP 20°							
MATERIALE / MATERIAL / WERKSTOFF / MATIÈRE		HSS-P	HSS-P	HSSE	HSSE	HSSE							
RIVESTIMENTO / COATING / BESCHICHTUNG / REVÊTEMENT		NI	TiCN	BR	TiCN	TiN							
NORMA / NORM / NORM / NORME		DIN371	DIN371	DIN371	DIN371	DIN371							
TOLLERANZA / TOLERANCE / TOLERANZ / TOLÉRANCE		ISO2X(6HX)	ISO2X(6HX)	ISO2(6H)	ISO2(6H)	ISO2(6H)							
IMBOCCO / CHAMFER / ANSCHNITT / ENTRÉE		3P	3P	D(3.5P~5P)	D(3.5P~5P)	D(3.5P~5P)							
D	p	Ø	L	l	*	l1	d	k	Stock	Stock	Stock	Stock	Stock
M 2	0.4	1.6	45	8			2.8	2.1			●		
M 2.2	0.45	1.75	45	9			2.8	2.1					
M 2.3	0.4	1.9	45	9			2.8	2.1					
M 2.5	0.45	2.1	50	9			2.8	2.1			○		
M 2.6	0.45	2.2	50	9			2.8	2.1					
M 3	0.5	2.5	56	11	5	18	3.5	2.7	●	○	●	●	●
M 3.5	0.6	2.9	56	13		20	4	3					
M 4	0.7	3.3	63	13	7	21	4.5	3.4	●	○	●	●	●
M 5	0.8	4.2	70	16	9	25	6	4.9	●	○	●	●	●
M 6	1	5	80	19	11	30	6	4.9	●	○	●	●	●
M 7	1	6	80	19		30	7	5.5				●	
M 8	1.25	6.8	90	22	12	35	8	6.2	●	○	●	●	●
M 9	1.25	7.8	90	22		35	9	7					
M10	1.5	8.5	100	24	13	39	10	8	●	○	●	●	●

*I-1641N, 1641TC



M 2 ~ M 2.6			2	2	2
M 3 ~ M10	3	3	3	3	3

🇮🇹 MASCHI A MACCHINA PER FORI CIECHI

🇬🇧 BLIND HOLES MACHINE TAPS

🇩🇪 MASCHINENGEWINDEBOHRER FÜR GRUNDLÖCHER

🇫🇷 TARAUDS MACHINE POUR TROUS BORGNES



2 3 4
5 14 19

9641X
LOSP 20°
HSSE
OX
DIN371
ISO2(6H)
D(3.5P~5P)

Stock	D	p
●	M 2	0.4
○	M 2.2	0.45
○	M 2.3	0.4
●	M 2.5	0.45
○	M 2.6	0.45
●	M 3	0.5
	M 3.5	0.6
●	M 4	0.7
●	M 5	0.8
●	M 6	1
	M 7	1
●	M 8	1.25
	M 9	1.25
●	M10	1.5

2	M 2 ~ M 2.6
3	M 3 ~ M10

MASCHI A MACCHINA PER FORI CIECHI

BLIND HOLES MACHINE TAPS

MASCHINENGEWINDEBOHRER FÜR GRUNDLÖCHER

TARAUDS MACHINE POUR TROUS BORGNES

M
DIN376

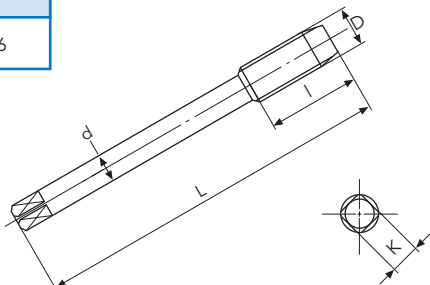

GRUPPI MATERIALE · MATERIAL GROUPS WERKSTOFFE GRUPPE · GROUPES MATIÈRE								4 5 22	4 5	2 3 4 5 14 19	2 3 4 5 14 19	2 3 4 5 14 19
CODICE / ITEM NO. / ARTIKEL NR. / RÉFÉRENCE								1741N	1741TC	9741	9741TC	9741TI
TIPO / TYPE / TYP / TYPE								ZET-B	ZET-B	LOSP*	LOSP*	LOSP*
MATERIALE / MATERIAL / WERKSTOFF / MATIÈRE								HSS-P	HSS-P	HSSE	HSSE	HSSE
RIVESTIMENTO / COATING / BESCHICHTUNG / REVÊTEMENT								NI	TiCN	BR	TiCN	TiN
NORMA / NORM / NORM / NORME								DIN376	DIN376	DIN376	DIN376	DIN376
TOLLERANZA / TOLERANCE / TOLERANZ / TOLÉRANCE								ISO2X(6HX)	ISO2X(6HX)	ISO2(6H)	ISO2(6H)	ISO2(6H)
IMBOCCO / CHAMFER / ANSCHNIITT / ENTRÉE								3P	3P	D(3.5P~5P)	D(3.5P~5P)	D(3.5P~5P)
D	p	Ø	L	l	*	d	k	Stock	Stock	Stock	Stock	Stock
M 3	0.5	2.5	56	11		2.2						
M 4	0.7	3.3	63	13		2.8	2.1					
M 5	0.8	4.2	70	16		3.5	2.7					
M 6	1	5	80	19		4.5	3.4					
M 8	1.25	6.8	90	22		6	4.9					
M10	1.5	8.5	100	24		7	5.5					
M12	1.75	10.3	110	29	15	9	7	●	○	●	●	●
M14	2	12	110	30	18	11	9	●	○	●	●	●
M16	2	14	110	32	18	12	9	●	○	●	●	●
M18	2.5	15.5	125	34	20	14	11	△	△	●	○	○
M20	2.5	17.5	140	34	20	16	12	●	○	●	○	○
M22	2.5	19.5	140	34	20	18	14.5	△	△			
M24	3	21	160	38	25	18	14.5	△	△			
M27	3	24	160	38		20	16					
M30	3.5	26.5	180	45		22	18					
M33	3.5	29.5	180	50		25	20					
M36	4	32	200	56		28	22					
M39	4	35	200	60		32	24					
M42	4.5	37.5	200	60		32	24					
M45	4.5	40.5	220	65		36	29					
M48	5	43	250	70		36	29					

M 3 ~ M24 LOSP=20°

M27 ~ M48 LOSP=15°

*I-1741N, 1741TC



M 3					
M 4 ~ M16	3	3	3	3	3
M18 ~ M48	4	4	4	4	4

🇮🇹 MASCHI A MACCHINA PER FORI CIECHI

🇬🇧 BLIND HOLES MACHINE TAPS

🇩🇪 MASCHINENGEWINDEBOHRER FÜR GRUNDLÖCHER

🇫🇷 TARAUDS MACHINE POUR TROUS BORGNES



2 3 4
5 14 19

9741X		
LOSP*		
HSSE		
OX		
DIN376		
ISO2(6H)		
D(3.5P~5P)		
Stock	D	p
●	M 3	0.5
●	M 4	0.7
●	M 5	0.8
●	M 6	1
●	M 8	1.25
●	M10	1.5
●	M12	1.75
●	M14	2
●	M16	2
●	M18	2.5
●	M20	2.5
●	M22	2.5
●	M24	3
●	M27	3
●	M30	3.5
	M33	3.5
	M36	4
	M39	4
	M42	4.5
	M45	4.5
	M48	5

2	M 3
3	M 4 ~ M16
4	M18 ~ M48

MASCHI A MACCHINA PER FORI CIECHI - MAGGIORATI

BLIND HOLES MACHINE TAPS - OVERSIZED

MASCHINENGEWINDEBOHRER FÜR GRUNDLÖCHER - ÜBERMAB

TARAUDS MACHINE POUR TROUS BORGNES - SURCOTÉS

M
DIN371

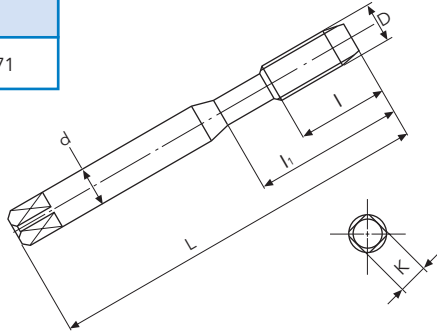

GRUPPI MATERIALE · MATERIAL GROUPS WERKSTOFFE GRUPPE · GROUPES MATIÈRE		2 3 4 5 14 19	2 3 4 5 14 19	2 3 4 5 14 19	2 3 4 5 14 19	2 3 4 5 14 19						
CODICE / ITEM NO. / ARTIKEL NR. / RÉFÉRENCE		9641X6G	964105	9641TI05	9641X05	964110						
TIPO / TYPE / TYP / TYPE		LOSP 20°	LOSP 20°	LOSP 20°	LOSP 20°	LOSP 20°						
MATERIALE / MATERIAL / WERKSTOFF / MATIÈRE		HSSE	HSSE	HSSE	HSSE	HSSE						
RIVESTIMENTO / COATING / BESCHICHTUNG / REVÊTEMENT		OX	BR	TiN	OX	BR						
NORMA / NORM / NORM / NORME		DIN371	DIN371	DIN371	DIN371	DIN371						
TOLLERANZA / TOLERANCE / TOLERANZ / TOLÉRANCE		ISO3(6G)	ISO2(6H) +0.05	ISO2(6H) +0.05	ISO2(6H) +0.05	ISO2(6H) +0.10						
IMBOCCO / CHAMFER / ANSCHNITT / ENTRÉE		D(3.5P~5P)	D(3.5P~5P)	D(3.5P~5P)	D(3.5P~5P)	D(3.5P~5P)						
D	p	Ø	L	l	l1	d	k	Stock	Stock	Stock	Stock	Stock
M 2	0.4	1.6	45	8		2.8	2.1					
M 2.5	0.45	2.1	50	9		2.8	2.1					
M 2.6	0.45	2.2	50	9		2.8	2.1					
M 3	0.5	2.5	56	11	18	3.5	2.7	●	●	○	●	△
M 3.5	0.6	2.9	56	13	20	4	3					
M 4	0.7	3.3	63	13	21	4.5	3.4	●	●	○	●	△
M 5	0.8	4.2	70	16	25	6	4.9	●	●	○	●	△
M 6	1	5	80	19	25	6	4.9	●	●	○	●	△
M 8	1.25	6.8	90	22	35	8	6.2	●	●	○	●	△
M10	1.5	8.5	100	24	39	10	8	●	●	○	●	△



M 2 ~ M 3	2	2	2	2	2
M 3.5 ~ M10	3	3	3	3	3

🇮🇹 MASCHI A MACCHINA PER FORI CIECHI - MAGGIORATI

🇬🇧 BLIND HOLES MACHINE TAPS - OVERSIZED

🇩🇪 MASCHINENGEWINDEBOHRER FÜR GRUNDLÖCHER - ÜBERMAß

🇫🇷 TARAUDS MACHINE POUR TROUS BORGNES - SURCOTÉS

M
DIN376

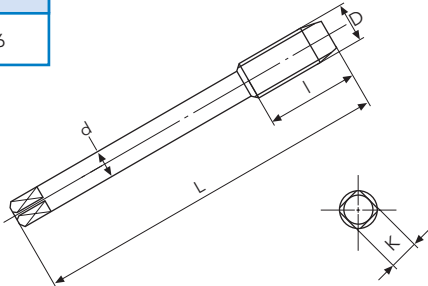

GRUPPI MATERIALE · MATERIAL GROUPS WERKSTOFFE GRUPPE · GROUPES MATIÈRE	2 3 4 5 14 19	2 3 4 5 14 19	2 3 4 5 14 19	2 3 4 5 14 19	2 3 4 5 14 19						
CODICE / ITEM NO. / ARTIKEL NR. / RÉFÉRENCE	9741X6G	974105	9741TI05	9741X05	974110						
TIPO / TYPE / TYP / TYPE	LOSP 20°	LOSP 20°	LOSP 20°	LOSP 20°	LOSP 20°						
MATERIALE / MATERIAL / WERKSTOFF / MATIÈRE	HSSE	HSSE	HSSE	HSSE	HSSE						
RIVESTIMENTO / COATING / BESCHICHTUNG / REVÊTEMENT	OX	BR	TiN	OX	BR						
NORMA / NORM / NORM / NORME	DIN376	DIN376	DIN376	DIN376	DIN376						
TOLLERANZA / TOLERANCE / TOLERANZ / TOLÉRANCE	ISO3(6G)	ISO2(6H) +0.05	ISO2(6H) +0.05	ISO2(6H) +0.05	ISO2(6H) +0.10						
IMBOCCO / CHAMFER / ANSCHNITT / ENTRÉE	D(3.5P~5P)	D(3.5P~5P)	D(3.5P~5P)	D(3.5P~5P)	D(3.5P~5P)						
D	p	Ø	L	l	d	k	Stock	Stock	Stock	Stock	Stock
M12	1.75	10.3	110	29	9	7	●	△	△	△	△
M14	2	12	110	30	11	9	●	△	△	△	△
M16	2	14	110	32	12	9	●	△	△	△	△
M18	2.5	15.5	125	34	14	11	△	△	△	△	△
M20	2.5	17.5	140	34	16	12	△	△	△	△	△



M12 ~ M16	3	3	3	3	2
M18 ~ M20	4	4	4	4	3